



MAKING BALUSTRADE EASY

CONTENTS

3

SWR BALUSTRADE

3

Contact Us

3

Service The SWR Way

3

Quality Assured

4

Grade Selection - AISI 304 or AISI 306 or Satin?

4

Glass

6

MODULAR SYSTEM

7

Satin Components

17

Glass Clamp Infill

18

Wire Rope Infill

20

Rod Infill

22

NEW GLASS CHANNEL SYSTEM

23

Overview

24

Channel Components

26

Satin Handrail Components

29

STAND OFF BRACKETS

29

Overview

31

FIXINGS

31

Overview

32

Components

35

HELP & ADVICE

35

Loading & Building Regulations

35

Cutting, Drilling & Polishing

36

Cleaning & Maintenance

36

Online Quote Configurator

37

Fitting Instructions

41

Also Available from SWR



CONTACT US



01442 210751



sales@swr-balustrade.co.uk



SWR Ltd, Units 2-4 Eastman Way,
Hemel Hempstead, Hertfordshire, HP2 7DU

Office Hours: Mon - Thurs 8:30-16:30 | Fri 8:30-15:30 | Sat 10:00-15:00



SERVICE THE SWR WAY

At SWR, our priority is to provide you with a premium, hard-wearing and safe balustrade system. Our experienced team will guide you through the entire process, from initial design to final installation.

Designing and installing your balustrade system is easier than you may think. Just send us your sketches, photographs or technical drawings and we will help turn your vision into reality.

Because when it comes to safety, quality, and service... **WE GO BEYOND**

QUALITY ASSURED

As an ISO 9001:2008 approved company, quality informs everything we do. That's why our balustrade systems are designed and manufactured to comply with all industry standards. Our systems have been rigorously tested by The British Standards Institute to BS 6180. To download the reports and for further technical information please visit: www.swr-balustrade.co.uk/knowledge or contact our Sales Team.



GRADE SELECTION – AISI 304 OR AISI 316?

Our balustrade range is comprised of AISI 304 and AISI 316 stainless steel. Both are available in a 320 grit brushed satin finish.

Although they look the same, AISI 304 and 316 stainless share different chemical compositions. As a rule, AISI 316 is more resistant to corrosion and more suitable for outdoor use.

The table below can be used as a rough guide to which grade/finish is appropriate for certain environments:

	Rural		Urban		Industrial		Coastal	
	Internal	External	Internal	External	Internal	External	Internal	External
Satin 304	✓	✗	✓	✗	✗	✗	✗	✗
Satin 316	✓	✓	✓	✓	✓	✓	✓	✗

GLASS

We guarantee that all glass supplied by us is manufactured in accordance with BS EN 12600:2002 safety standards. For your peace of mind, our dedicated team will work closely with you to determine your best glass option based on the load requirements.

We are partnered with a top glass processor who has been a leading supplier of architectural products and safety glass since 1985. Whether you need domestic balustrade for your patio or a large commercial development, we can supply the right product for your project.

Choosing The Right Glass

When you contact us, we will ask key questions to ensure you get the right glass system:

- What height of glass do you require?
- Is your system internal or external?
- Is a stainless steel handrail required?
- What loading does the glass balustrade need to achieve?

We will also discuss the thickness of glass required and whether you need toughened, laminated and toughened, or heat-soaked glass.

GLASS

Toughened glass is suitable for most applications where safety is critical. However, you should consider toughened and laminated glass if the balustrade is elevated. This is because the laminate interlayer retains glass fragments and act as a barrier if the pane is broken.

Your balustrade is designed to be an important safety feature. As a result, we can use a structural glass consultancy to determine what type of glass your project requires. A written report can also be provided for your peace of mind.

Delivery To Your Door

SWR's courier can deliver your glass to most locations on the UK mainland. Rest assured, your order will arrive quickly and in perfect condition.

All delivered glass will have polished edges and dubbed corners as standard unless otherwise requested. Please note, we can also supply frosted/sandblast, silkscreen printed and etched versions.

For further information on glass, installation guides, building regulations and our test results, please visit: www.swr-balustrade.co.uk/knowledge or contact our Sales Team.



MODULAR SYSTEM

Our most popular system - strong, stunning and versatile

SATIN TUBE

SWR's stainless steel post and handrail system is designed to provide a user friendly solution for the most bespoke balustrade requirements. The stylish modular system is available in a variety of contemporary infill solutions including glass, wire or rod; giving you complete freedom of design.

Our satin product range includes both AISI 304 and AISI 316 grade stainless steel in 42.4mm and 48.3mm. Idea for both residential and commercial projects.

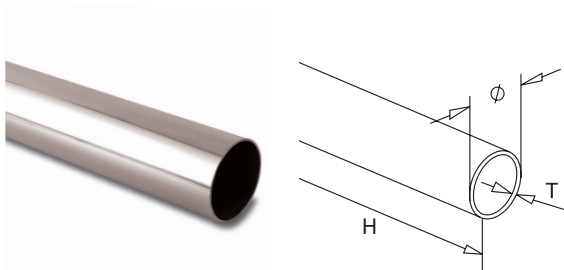

TUBE				
Ø	T	H	Grade	Part Code
42.4	2.0	Up to 6m	AISI 304	4220.11.910
42.4	2.0	Up to 6m	AISI 316	4826.11.910
48.3	2.6	Up to 6m	AISI 304	6220.11.910
48.3	2.6	Up to 6m	AISI 316	6826.11.910



SATIN BASE & WALL FIXINGS

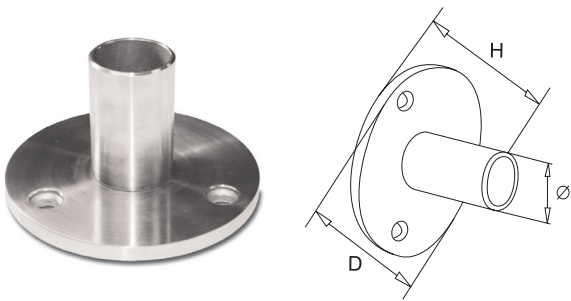

BASE PLATE

For Tube	H	D	Ø	Grade	Part Code
42.4	67	120	38.3	AISI 304	4220.12.010
42.4	67	120	38.3	AISI 316	6220.12.010

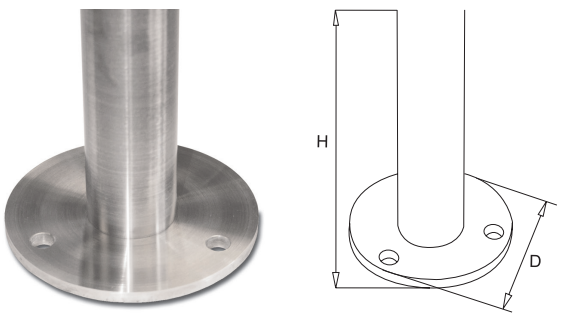

BASE PLATE & FLOOR POST (1050mm)

For Tube	H	D	Grade	Part Code
42.4	1050	120	AISI 304	4220.12.011
42.4	1050	120	AISI 316	6220.12.011

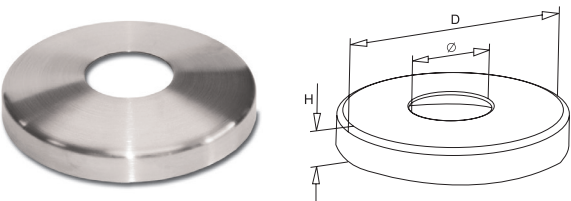

BASE PLATE COVER

For Tube	H	D	Ø	Grade	Part Code
42.4	18	125	42.5	AISI 304	4220.12.019
42.4	18	125	42.5	AISI 316	6220.12.019



SATIN BASE & WALL FIXINGS

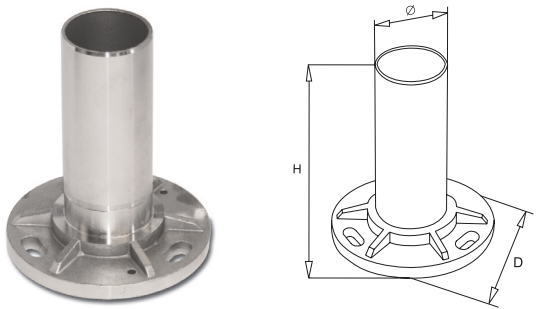

HEAVY DUTY BASE PLATE

For Tube	H	D	Ø	Grade	Part Code
42.4	100	100	38.3	AISI 304	4220.12.030
42.4	100	100	38.3	AISI 316	6220.12.030
48.3	117	100	43	AISI 304	4826.12.030
48.3	117	100	43	AISI 316	6826.12.030

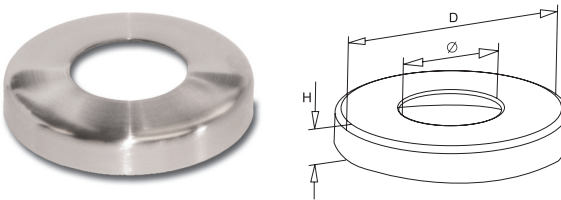

HEAVY DUTY BASE PLATE COVER

For Tube	H	D	Ø	Grade	Part Code
48.3	17	105	48.4	AISI 304	4800.12.039
48.3	17	105	48.4	AISI 316	6800.12.039

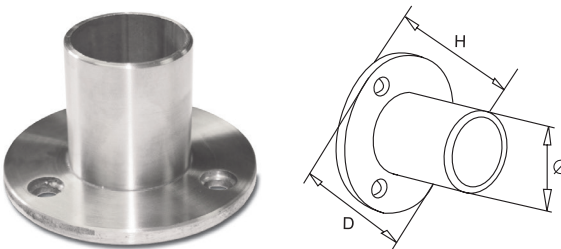

WALL PLATE

For Tube	H	D	Ø	Grade	Part Code
42.4	48	79	38.3	AISI 304	4220.12.020
42.4	48	79	38.3	AISI 316	6220.12.020
48.3	68	79	43	AISI 304	4826.12.020
48.3	68	79	43	AISI 316	6826.12.020

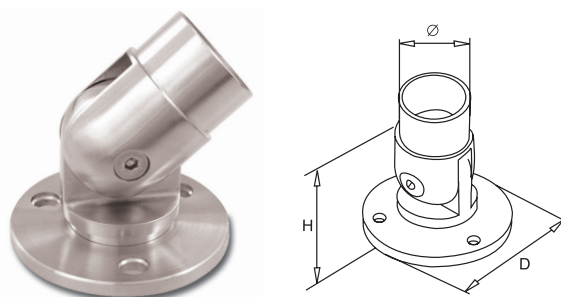

ARTICULATED WALL PLATE

For Tube	H	D	Ø	Grade	Part Code
42.4	65	80	38.3	AISI 304	4220.12.021
42.4	65	80	38.3	AISI 316	6220.12.021

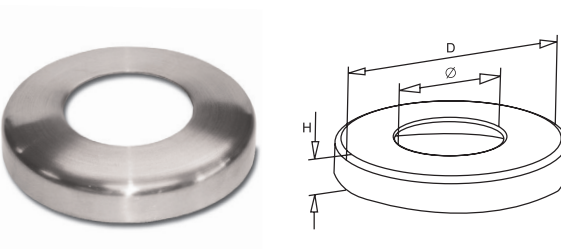

WALL PLATE COVER

For Tube	H	D	Ø	Grade	Part Code
42.4	16	84	42.5	AISI 304	4220.12.029
42.4	16	84	42.5	AISI 316	6220.12.029

All dimensions are in millimetres unless otherwise stated.

SATIN BASE & WALL FIXINGS

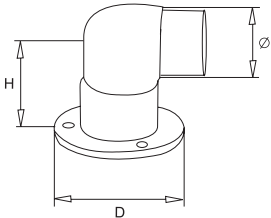

SHORT 90° BASE PLATE

For Tube	H	D	Ø	Grade	Part Code
42.4	51.2	76	42.4	AISI 304	4220.12.090
42.4	51.2	76	42.4	AISI 316	6220.12.090

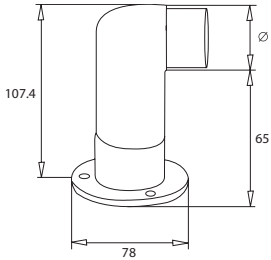

LONG 90° BASE PLATE

For Tube	Ø	Grade	Part Code
42.4	42.4	AISI 304	4220.12.100
42.4	42.4	AISI 316	6220.12.100

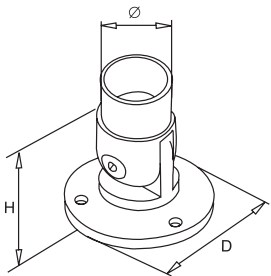

ARTICULATED BASE PLATE

For Tube	H	D	Ø	Grade	Part Code
48.3	70	90	48.3	AISI 316	6826.12.483

SATIN BASE & WALL FIXINGS

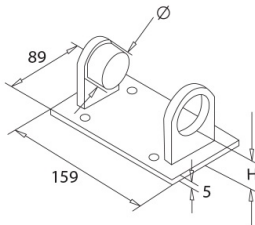
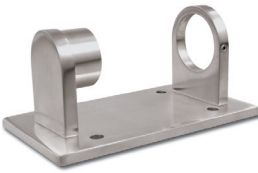

POST HOLDER

For Tube	H	Ø	Grade	Part Code
42.4	27	38.3	AISI 304	4220.12.101
42.4	27	38.3	AISI 316	6220.12.101
48.3	30	43	AISI 304	4826.12.101
48.3	30	43	AISI 316	6826.12.101

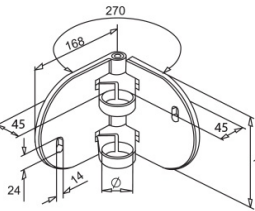
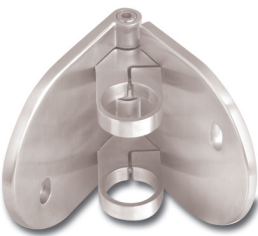

HINGED POST HOLDER

For Tube	Ø	Grade	Part Code
42.4	42.5	AISI 304	4220.12.555
42.4	42.5	AISI 316	6220.12.555
48.3	48.4	AISI 304	4826.12.555
48.3	48.4	AISI 316	6826.12.555

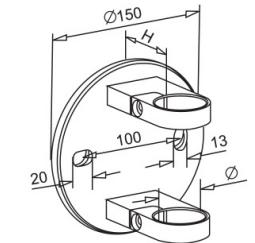

ROUND POST HOLDER

For Tube	Ø	Grade	Part Code
42.4	42.5	AISI 304	4220.12.551
42.4	42.5	AISI 316	6220.12.551
48.3	48.4	AISI 304	4826.12.551
48.3	48.4	AISI 316	6826.12.551

All dimensions are in millimetres unless otherwise stated.

SATIN BENDS, ELBOWS & TEES

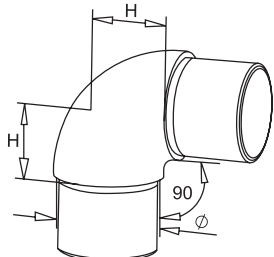

90° CURVED ELBOW

For Tube	H	Ø	Grade	Part Code
42.4	31.3	42.4	AISI 304	4220.15.160
42.4	31.3	42.4	AISI 316	6220.15.160
48.3	35	48.3	AISI 304	4826.15.160
48.3	35	48.3	AISI 316	6826.15.160

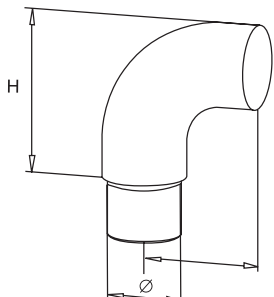

90° CURVED ELBOW M/F (with Cap)

For Tube	H	Ø	Grade	Part Code
42.4	83	42.4	AISI 304	4220.15.165
42.4	83	42.4	AISI 316	6220.15.165
48.3	84	48.3	AISI 304	4826.15.165
48.3	84	48.3	AISI 316	6826.15.165

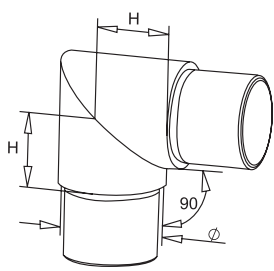

90° SHARP ELBOW

For Tube	H	Ø	Grade	Part Code
42.4	30	42.4	AISI 304	4220.15.170
42.4	30	42.4	AISI 316	6220.15.170
48.3	35	48.3	AISI 304	4826.15.170
48.3	35	48.3	AISI 316	6826.15.170

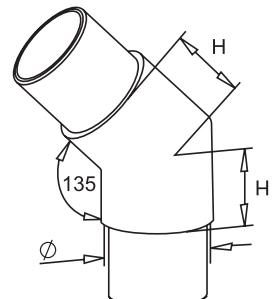

45° ELBOW

For Tube	H	Ø	Grade	Part Code
42.4	42.4	42.4	AISI 304	4220.15.175
42.4	42.4	42.4	AISI 316	6220.15.175

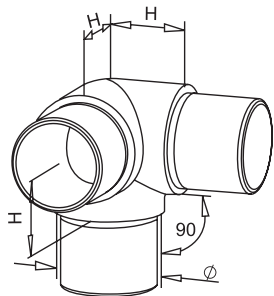

THREE WAY ELBOW

For Tube	H	Ø	Grade	Part Code
42.4	30	42.4	AISI 304	4220.15.190
42.4	30	42.4	AISI 316	6220.15.190
48.3	35	48.3	AISI 304	4826.15.190
48.3	35	48.3	AISI 316	6826.15.190

SATIN BENDS, ELBOWS & TEES

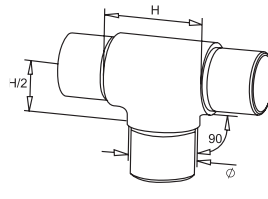

EQUAL TEE

For Tube	H	Ø	Grade	Part Code
42.4	60	42.4	AISI 304	4220.15.210
42.4	60	42.4	AISI 316	6220.15.210
48.3	70	48.3	AISI 304	4826.15.210
48.3	70	48.3	AISI 316	6826.15.210

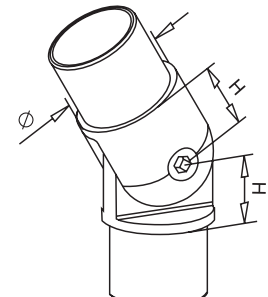

ARTICULATED ELBOW

For Tube	H	Ø	Grade	Part Code
42.4	27	42.4	AISI 304	4220.15.250
42.4	27	42.4	AISI 316	6220.15.250
48.3	30	48.3	AISI 304	4826.15.250
48.3	30	48.3	AISI 316	6826.15.250

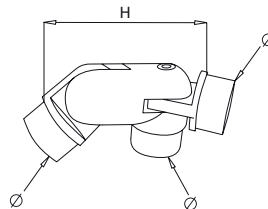

THREE WAY ARTICULATED JOINT

For Tube	H	Ø	Grade	Part Code
42.4	104	42.4	AISI 304	4220.15.251
42.4	104	42.4	AISI 316	6220.15.251
48.3	112	48.3	AISI 304	4826.15.251
48.3	112	48.3	AISI 316	6826.15.251

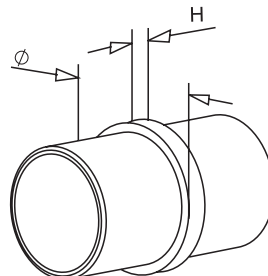
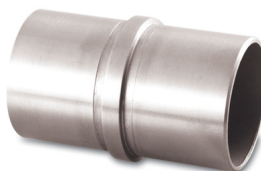

STRAIGHT CONNECTOR

For Tube	H	Ø	Grade	Part Code
42.4	6	42.4	AISI 304	4220.15.280
42.4	6	42.4	AISI 316	6220.15.280
48.3	6	48.3	AISI 304	4826.15.280
48.3	6	48.3	AISI 316	6826.15.280

All dimensions are in millimetres unless otherwise stated.

SATIN END CAPS

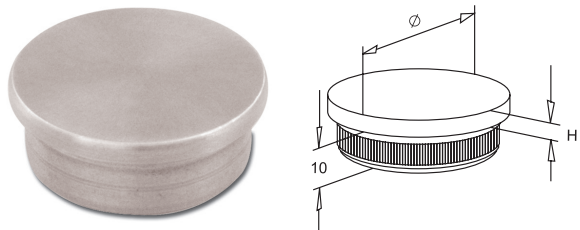

FLAT CAPPING PLUG (Stainless Steel)

For Tube	H	Ø	Grade	Part Code
42.4	2.5	42.4	AISI 304	4220.15.140
42.4	2.5	42.4	AISI 316	6220.15.140

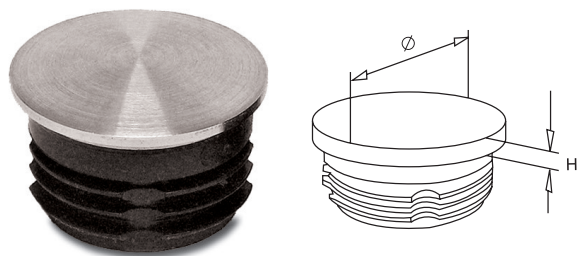

FLAT CAPPING PLUG (Plastic Sleeve)

For Tube	H	Ø	Grade	Part Code
48.3	8	48.3	AISI 304	4826.15.140
48.3	8	48.3	AISI 316	6826.15.140

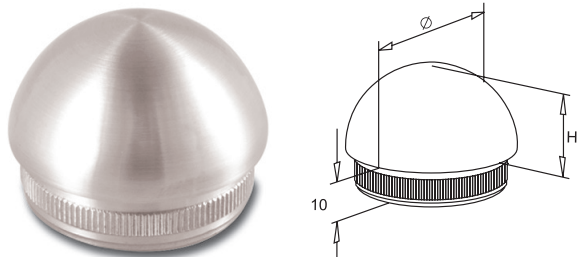

ROUND CAPPING PLUG (Stainless Steel)

For Tube	H	Ø	Grade	Part Code
42.4	21	42.4	AISI 304	4220.15.155
42.4	21	42.4	AISI 316	6220.15.155

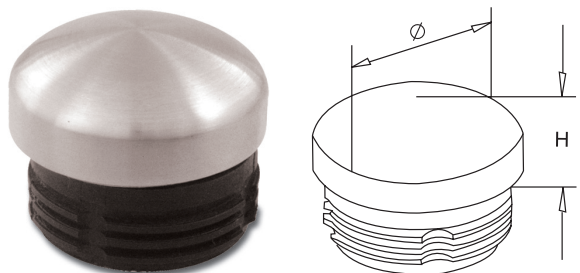

ROUND CAPPING PLUG (Plastic Sleeve)

For Tube	H	Ø	Grade	Part Code
42.4	15	42.4	AISI 304	4220.15.150
42.4	15	42.4	AISI 316	6220.15.150
48.3	15	48.3	AISI 304	4826.15.150
48.3	15	48.3	AISI 316	6826.15.150

SATIN HANDRAIL BRACKETS

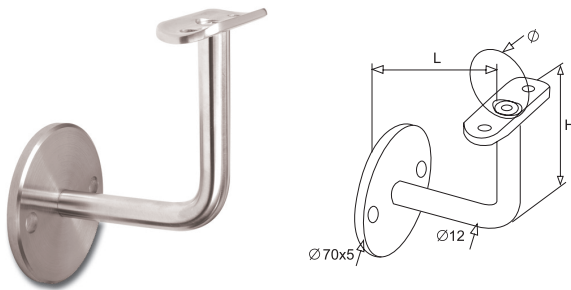

WALL BRACKET

For Tube	H	L	Ø	Grade	Part Code
42.4	74	75	42.5	AISI 304	4200.13.040
42.4	74	75	42.5	AISI 316	6200.13.040

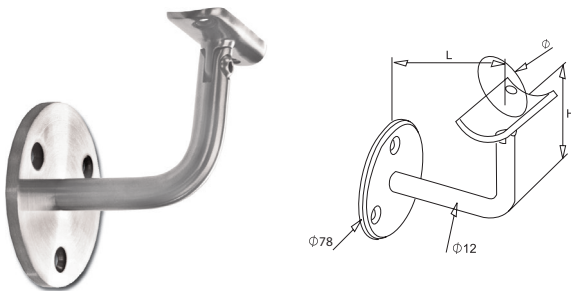

ARTICULATED WALL BRACKET

For Tube	H	L	Ø	Grade	Part Code
42.4	63	66	42.4	AISI 304	4200.13.041
42.4	63	66	42.4	AISI 316	6200.13.041
48.3	63	66	48.3	AISI 304	4800.13.041
48.3	63	66	48.3	AISI 316	6800.13.041

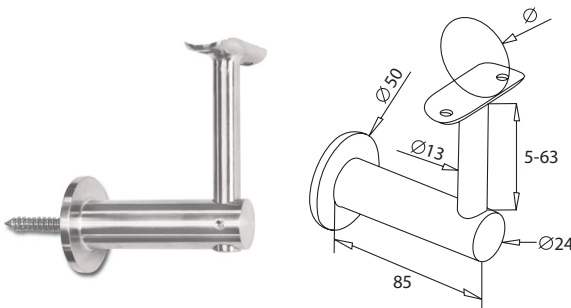

WALL BRACKET

For Tube	Ø	Grade	Part Code
42.4	42.4	AISI 304	4200.43.042
42.4	42.4	AISI 316	6200.43.042

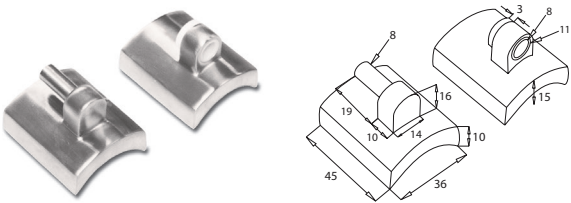

GATE HINGE

For Tube	Grade	Part Code
42.4	AISI 316	6200.21.500

All dimensions are in millimetres unless otherwise stated.

SATIN HANDRAIL BRACKETS

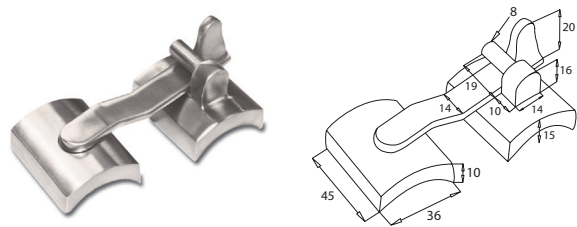

GATE LATCH

For Tube	Grade	Part Code
42.4	AISI 316	6200.21.520

Suitable for 12-13mm glass

SATIN HANDRAIL SUPPORTS

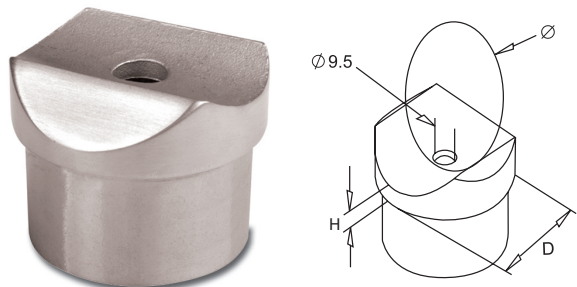

TUBE SADDLE

For Tube	H	D	Ø	Grade	Part Code
42.4	9	42.4	42.4	AISI 304	4220.14.230
42.4	9	42.4	42.4	AISI 316	6220.14.230
48.3	5	48.3	48.3	AISI 304	4826.14.230
48.3	5	48.3	48.3	AISI 316	6826.14.230

STAND OFF ARTICULATED RAIL SUPPORT

For Tube	H	Ø	Grade	Part Code
42.4	78	42.4	AISI 304	4220.14.233
42.4	78	42.4	AISI 316	6220.14.233
48.3	79	48.3	AISI 304	4826.14.233
48.3	79	48.3	AISI 316	6826.14.233

90° HEART SHAPED SADDLE

For Tube	H	Ø	Grade	Part Code
42.4	79	42.4	AISI 316	6220.14.236
48.3	79	48.3	AISI 316	6826.14.236

All dimensions are in millimetres unless otherwise stated.

GLASS CLAMP INFILL

Create a contemporary look without obscuring the view.

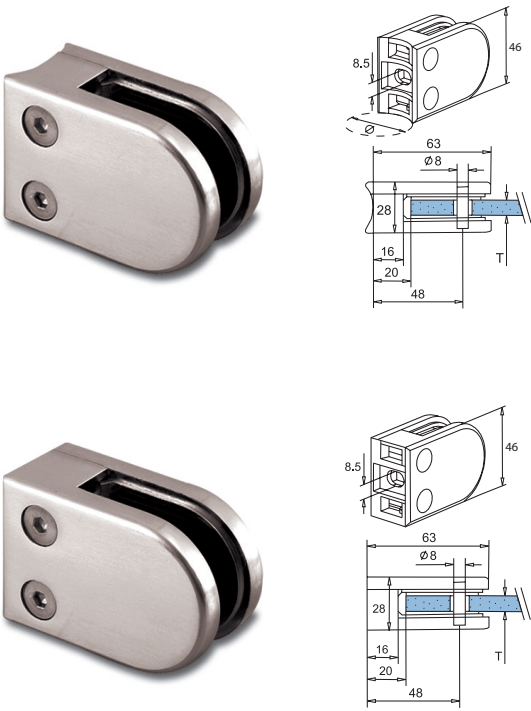

ROUND GLASS BRACKET

For Tube	Suit Glass T	Ø	Grade	Part Code
42.4	6-8	42.4	AISI 304	4200.16.260
42.4	6-8	42.4	AISI 316	6200.16.260
42.4	8-10	42.4	AISI 304	4200.16.261
42.4	8-10	42.4	AISI 316	6200.16.261
48.3	8-10	48.3	AISI 304	4800.16.261
48.3	8-10	48.3	AISI 316	6800.16.261
48.3	11.5	48.3	AISI 316	6800.16.115

FLAT GLASS BRACKET

Surface	Suit Glass T	Grade	Part Code
Flat	6-8	AISI 316	6F00.16.260
Flat	8-10	AISI 316	6F00.16.261



WIRE ROPE INFILL

A minimal finish, suitable for all applications.



WIRE INFILL COMPONENTS

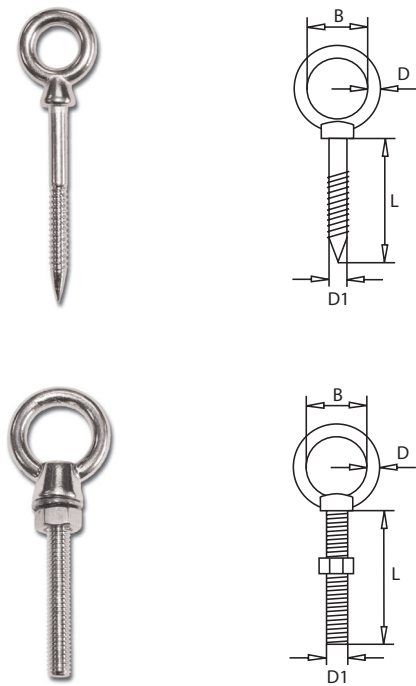

EYE BOLT (Wood Thread Stainless Steel)

D	L	B	WLL (Tons)	WT (kg)	Part Code
5	50	11	0.05	0.017	SSLEB05050L
6	60	14	0.08	0.028	SSLEB06060L
8	80	18	0.15	0.065	SSLEB06080L
10	100	22	0.22	0.127	SSLEB10100L

EYE BOLT (Metric Thread Stainless Steel)

D1	L	D	B	WLL (Tons)	WT (kg)	Part Code
M6	40	5	15	0.05	0.027	SSLEB06040
M6	60	5	15	0.05	0.030	SSLEB06060
M6	80	5	15	0.05	0.035	SSLEB06080
M8	80	6	20	0.08	0.065	SSLEB08080
M8	100	6	20	0.08	0.072	SSLEB08100
M10	100	8	25	0.15	0.130	SSLEB10100
M12	120	10	30	0.22	0.230	SSLEB12120

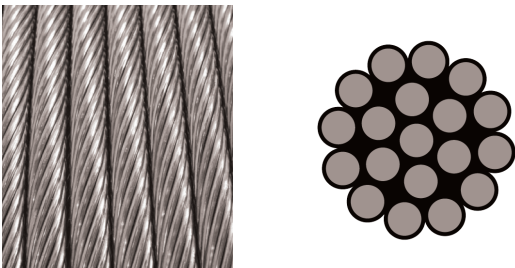

STAINLESS STEEL WIRE ROPE (1x19)

Diameter	Approx. Mass	Min. Breaking Load	Part Code
4	7.81kg/100m	12.6 force kN	SS119040
6	17.6kg/100m	28.2 force kN	SS119060

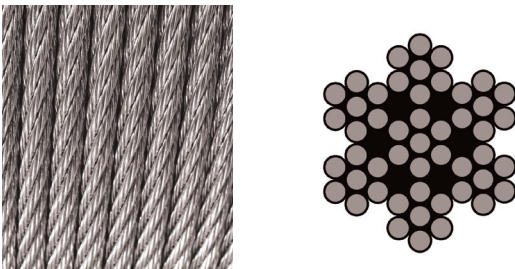
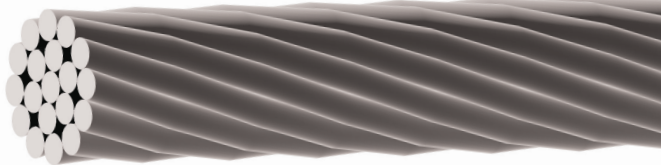

STAINLESS STEEL WIRE ROPE (7x7)

Diameter	Approx. Mass	Min. Breaking Load	Part Code
4	6.05kg/100m	9.49 force kN	SS770040
6	13.6kg/100m	21.4 force kN	SS770060

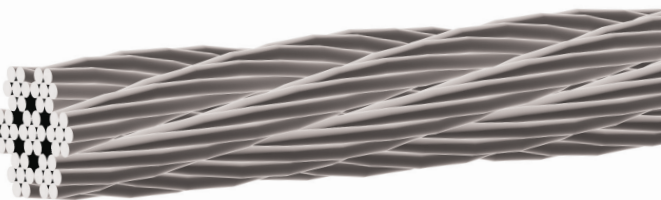

WIRE ROPE TENSION KIT

For Tube	Length	Grade	Part Code
Universal	3 metres	AISI 316	6000.23.003
Universal	5 metres	AISI 316	6000.23.005
Universal	10 metres	AISI 316	6000.23.010

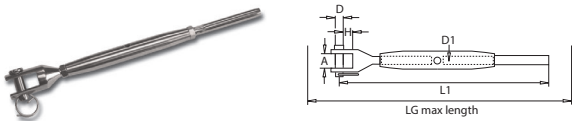

RIGGING SCREW

(Jaw & Wire Rope Terminal MT Form Stainless Steel)

D1	Wire	L1	A	D	H	LG	Part Code
M8	4	210	11	8	11	285	SSRFS0408M
M12	6	300	14	12	20	410	SSRFS0612M

ROD INFILL

A modern look with a sturdy, rigid finish.



ROD INFILL COMPONENTS

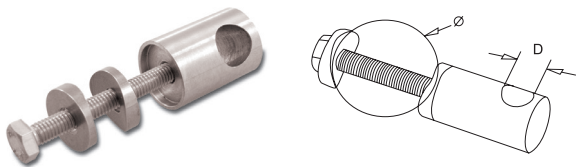

12mm ROD HOLDER

For Tube	D	Ø	Grade	Part Code
42.4	12.2	42.4	AISI 304	4200.20.311
42.4	12.2	42.4	AISI 316	6200.20.311
48.3	12.2	48.3	AISI 304	4800.20.311
48.3	12.2	48.3	AISI 316	6800.20.311

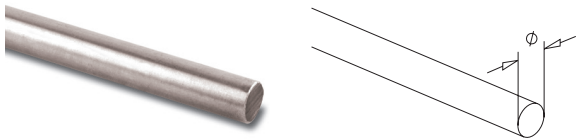

ROD

Ø	Length	Grade	Part Code
12	Up to 3m	AISI 304	4000.19.155
12	Up to 3m	AISI 316	6000.19.155



GLASS CHANNEL SYSTEM

Seamless, fashionable, and state of the art



OVERVIEW

Our frameless glass channel system consists of an aluminium channel with your choice of a base mounted or side mounted application. In addition, the improved clamping method ensures short installation times, and that the glass is fully stable.

Once the system is installed, glass can be easily removed to save you time and money. It's also fully tested to BS6180 building regulations and can achieve a maximum loading of 1.5Kn. We can also provide a 3Kn system if desired.

We can supply various cladding methods to protect your channel and cover any visible clamps on show, and you can choose to enhance your design with a satin stainless-steel handrail.

For further information on glass, installation guides, building regulations and our test results, please visit: www.swr-balustrade.co.uk/knowledge or contact our Sales Team.



COMPONENTS

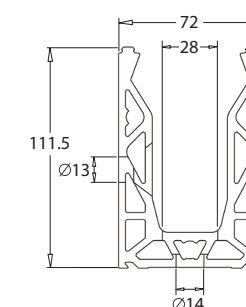
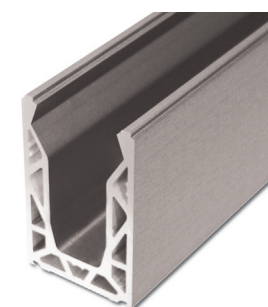

ALUMINIUM CHANNEL

Fixing	Length	To Suit Glass	Part Code
Floor	Up to 3m	12 - 21.5	0000.31.400
Side	Up to 3m	12 - 21.5	0000.31.401

Suitable for glass sized 12mm-21.5mm - please call for further details.

CHANNEL COMPONENTS

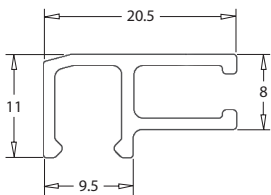

ALUMINIUM TOP SEAL STRIP

Length	Part Code
Up to 3m	6000.32.050

2m required with every 1m of Base Fixed Channel
1m required with every 1m of Side Fixed Channel

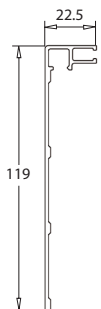

ALUMINIUM SIDE CLADDING

Length	Part Code
Up to 3m	6000.32.030

1m required with every 1m of Side Fixed Channel

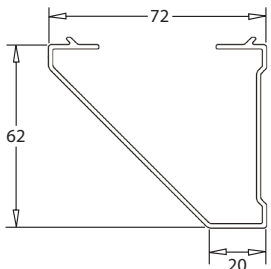
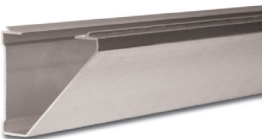

ALUMINIUM BOTTOM CLADDING

Length	Part Code
Up to 3m	6000.32.040

Optional - 1m required with every 1m of Side Fixed Channel

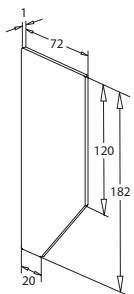

ALUMINIUM END PLATE - BOTTOM CLADDING

Position	Part Code
Left	6000.32.06L
Right	6000.32.06R

Required with Bottom Cladding

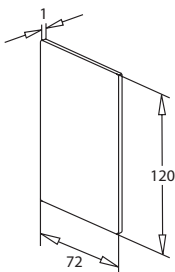

ALUMINIUM END PLATE - BASE FIXED

Part Code
6000.32.070

Used when fitting Top Seal only to Channel

CHANNEL COMPONENTS

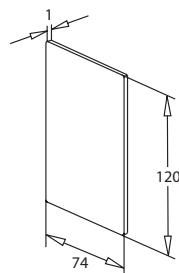

ALUMINIUM END PLATE - SIDE FIXED

Part Code
6000.32.074

Used when fitting Top Seal one side of the Channel and Side Cladding to the other.

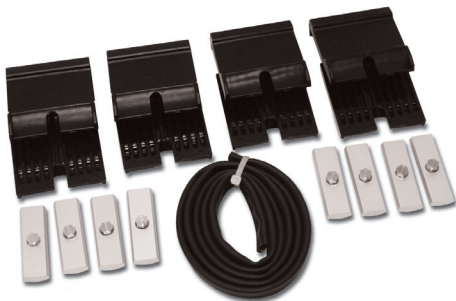

CLAMPING WEDGES & COVER SEAL

Suit Glass	Quantity	Part Code
12	Pack of 4	0000.33.312
15	Pack of 4	0000.33.315
17.5	Pack of 4	0000.33.317
19	Pack of 4	0000.33.319
21.5	Pack of 4	0000.33.321

Pack includes 4 Clamping Wedges and all necessary bolts with 2m of Rubber Gasket - everything required for 1m of channel

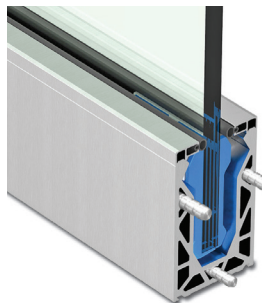

PACK OF 2
ALUMINIUM CHANNEL CONNECTING DOWELS

Quantity	Part Code
Pack of 2	6000.33.080

Optional - 1 pack required per Channel connection



STAINLESS STEEL 10mm HEAD SPANNER

Part Code
0000.90.300

Required to tighten Clamping Wedges

SATIN HANDRAIL COMPONENTS

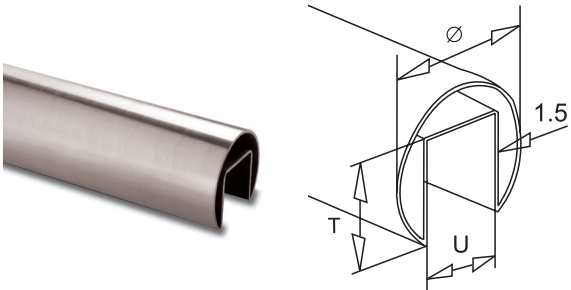

SLOTTED TUBE

Length	Ø	T	U	Grade	Part Code
Up to 6m	42.4	24	24	AISI 304	4215.41.910
Up to 6m	42.4	24	24	AISI 316	6215.41.910
Up to 6m	48.3	30	27	AISI 304	4815.41.910
Up to 6m	48.3	30	27	AISI 316	6815.41.910

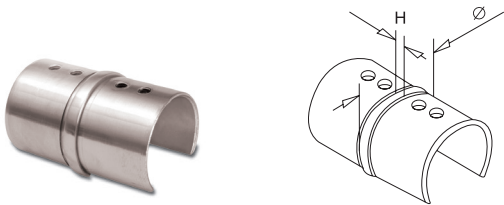

STRAIGHT CONNECTOR

For Tube	H	Ø	Grade	Part Code
42.4	6	42.4	AISI 304	4215.45.280
42.4	6	42.4	AISI 316	6215.45.280
48.3	6	48.3	AISI 316	6815.45.280

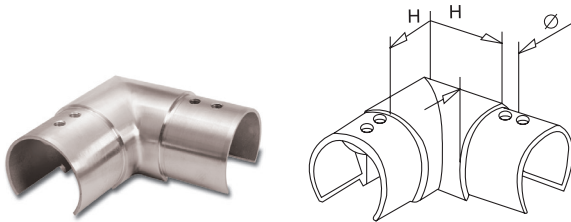

90° ELBOW (Horizontal)

For Tube	H	Ø	Grade	Part Code
42.4	30	42.4	AISI 316	6215.45.180
48.3	35	48.3	AISI 316	6815.45.180

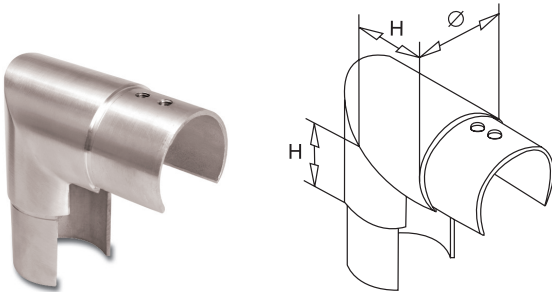

90° ELBOW (Vertical)

For Tube	H	Ø	Grade	Part Code
42.4	30	42.4	AISI 316	6215.45.170
48.3	35	48.3	AISI 316	6815.45.170

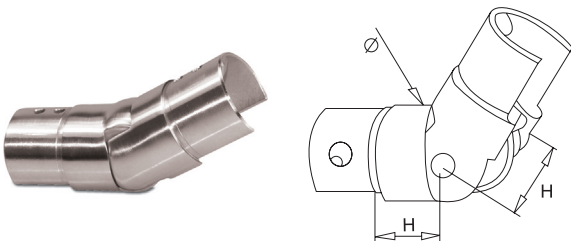

ADJUSTABLE SLOTTED ELBOW (25-55° Upward)

For Tube	H	Ø	Grade	Part Code
42.4	30	42.4	AISI 304	4215.45.190
42.4	30	42.4	AISI 316	6215.45.190
48.3	35	48.3	AISI 304	4815.45.190
48.3	35	48.3	AISI 316	6815.45.190

All dimensions are in millimetres unless otherwise stated.

SATIN HANDRAIL COMPONENTS

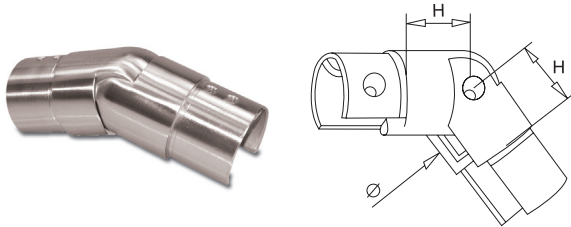

ADJUSTABLE SLOTTED ELBOW (25-55° Downward)

For Tube	H	Ø	Grade	Part Code
42.4	30	42.4	AISI 304	4215.45.195
42.4	30	42.4	AISI 316	6215.45.195
48.3	35	48.3	AISI 304	4815.45.195
48.3	35	48.3	AISI 316	6815.45.195

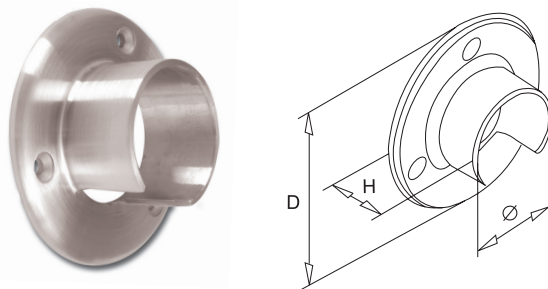

WALL MOUNTED BRACKET

For Tube	H	D	Ø	Grade	Part Code
42.4	30	90	39.3	AISI 304	4215.42.020
42.4	30	90	39.3	AISI 316	6215.42.020
48.3	35	95	45.2	AISI 304	4815.42.020
48.3	35	95	45.2	AISI 316	6815.42.020

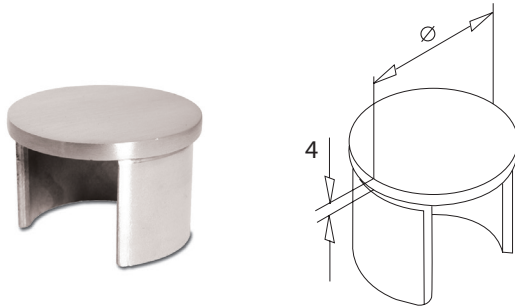

END CAP

For Tube	Ø	Grade	Part Code
42.4	42.4	AISI 304	4215.45.140
42.4	42.4	AISI 316	6215.45.140
48.3	48.3	AISI 304	4815.45.140
48.3	48.3	AISI 316	6815.45.140



RUBBER GASKET

For Tube	Length	To Suit Glass	Part Code
42.4	Up to 6m	8.0 - 10.76	0200.47.012
42.4	Up to 6m	12.0 - 16.76	0200.47.015
42.4	Up to 6m	16.76 - 18.0	0200.47.811
48.3	Up to 6m	8.0 - 13.0	0800.47.813
48.3	Up to 6m	13.0 - 17.52	0800.47.015
48.3	Up to 6m	18.0 - 21.5	0800.47.019

Rubber Gasket for other sizes of glass are available.

STAND OFF BRACKETS

Ideal for Juliet balconies and glass balustrade for your staircase or terrace

OVERVIEW

Install a structural glass balustrade in almost any location with stand-off brackets. Ideal for Juliet balconies, staircases or even terraces.

We provide a variety of bracket sizes from 10mm to 100mm (**S**). Available in 40mm & 50mm diameter (**Ø**). The brackets can incorporate 8mm, 10mm, 12mm or 15mm thick glass (**G**). Other glass thicknesses can be integrated upon request.

Brackets have a side drive hole in the boss for tightening and are supplied complete with soft parts. A 25mm diameter hole in the glass is required.



Satin finish

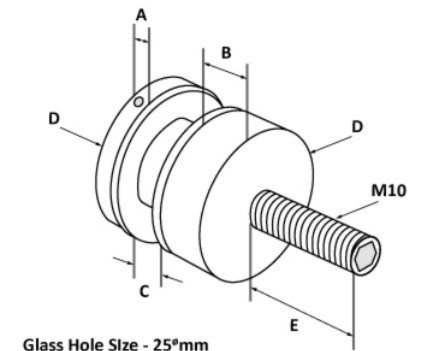

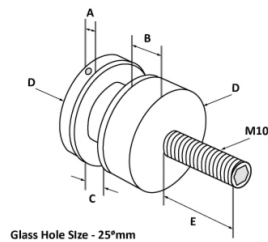

45mm GLASS ADAPTER - 10mm STAND-OFF

A	B	C	D	E	Grade	Part Code
6	10	8-20	45	46	AISI 304	4000.22.020
6	10	8-20	45	46	AISI 316	6000.22.020

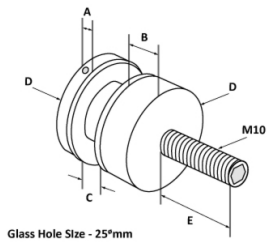

52mm GLASS ADAPTER - 10mm STAND-OFF

A	B	C	D	E	Grade	Part Code
6	10	10-20	52	46	AISI 304	4000.22.010
6	10	10-20	52	46	AISI 316	6000.22.010

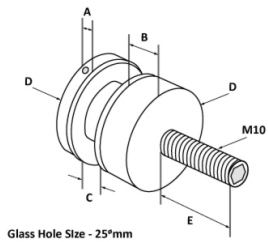

52mm GLASS ADAPTER - 30mm STAND-OFF

A	B	C	D	E	Grade	Part Code
6	30	10-20	52	46	AISI 304	4000.22.030
6	30	10-20	52	46	AISI 316	6000.22.030

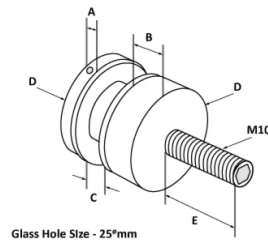

52mm GLASS ADAPTER - 50mm STAND-OFF

A	B	C	D	E	Grade	Part Code
6	50	10-20	52	46	AISI 304	4000.22.050
6	50	10-20	52	46	AISI 316	6000.22.050

All dimensions are in millimetres unless otherwise stated.

OVERVIEW

Not sure what fixings you need? We'll advise on what's required for each component and the most suitable fixing methods.

All fixings are high quality AISI 316 / A4 stainless steel and available directly from us.

For further information, please visit: www.swr-balustrade.co.uk/fixings or contact our Sales Team.



COMPONENTS



SOCKET CAP SCREW

Size	Length	Quantity	Part Code
M8	20	Packs of 10	6000.91.250



SOCKET BUTTON SCREW

Size	Length	Quantity	Part Code
M5	20	Packs of 10	6000.91.140



SELF TAPPING PAN HEAD SCREW

Gauge	Ø	Length	Quantity	Part Code
4	3	1 1/4" (30mm)	Pack of 12	6000.91.032
10	5	2" (50mm)	Pack of 12	6000.91.030



SELF TAPPING COUNTERSUNK SCREW

Gauge	Ø	Length	Quantity	Part Code
10	5	2" (50mm)	Pack of 12	6000.91.031



RAWL THROUGH BOLT

Size	Length	Quantity	Part Code
M8	95	Pack of 15	6000.91.260
M10	95	Pack of 15	6000.91.360
M12	100	Pack of 15	6000.91.460

COACH SCREW

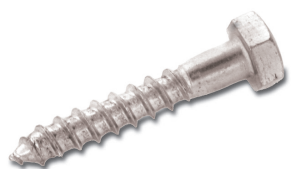

Size	Length	Quantity	Part Code
M8	100	Packs of 12	6000.91.210
M8	120	Packs of 12	6000.91.211
M10	100	Packs of 12	6000.91.310
M10	120	Packs of 12	6000.91.311
M12	100	Packs of 12	6000.91.410
M12	120	Packs of 12	6000.91.411

STUDDING



Size	Quantity	Part Code
M8	Per Metre	6000.91.220
M10	Per Metre	6000.91.320
M12	Per Metre	6000.91.420

COMPONENTS



ROUND WASHERS

Size	Quantity	Part Code
M8	Pack of 25	6000.91.280
M10	Pack of 25	6000.91.380
M12	Pack of 25	6000.91.480



DOME NUTS

Size	Quantity	Part Code
M8	Pack of 10	6000.91.271
M10	Pack of 10	6000.91.371
M12	Pack of 10	6000.91.471



HEX NUTS

Size	Quantity	Part Code
M8	Pack of 10	6000.91.270
M10	Pack of 10	6000.91.370
M12	Pack of 10	6000.91.470



POLYESTER RESIN

Size	Quantity	Part Code
410ml	Per bottle	0000.62.020



MIXER NOZZLES

Size	Quantity	Part Code
For use with all cartridges	Pack of 10	0000.90.002



STRUCTURAL ADHESIVE

Size	Quantity	Part Code
25ml	Per syringe	0000.61.637

COMPONENTS



DRILL BITS

Ø	Part Code
3.2	0000.90.032
4.1	0000.90.041
5.0	0000.90.050
6.5	0000.90.065
6.8	0000.90.068



TAPPERS

Size	Part Code
M3	0000.90.003
M4	0000.90.004
M5	0000.90.005
M6	0000.90.006
M8	0000.90.008



TAPPING WRENCH

Part Code
0000.90.285



CHEMICAL INJECTION TOOL

Size	Part Code
Fits 380-410ml cartridge	0000.90.090



STAINLESS STEEL 10mm HEAD SPANNER

Part Code
0000.90.300

Required to tighten Clamping Wedges

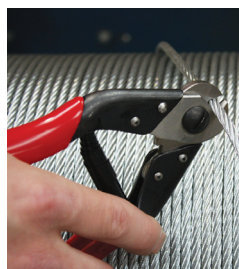

WIRE ROPE CUTTERS

PART CODE: SWR0060

Type of Wire/Material	Max. Cutting Capacities
1770 - 1960 Grade Wire Rope	4mm

All dimensions are in millimetres unless otherwise stated.

LOADING & BUILDING REGULATIONS

Safety is our top priority when considering the most suitable balustrade system. That's why we collaborate closely with our client to provide the most up-to-date advice on loading and dimensional specifications - in line with The Building Regulations K2 Document.

In addition, our systems are rigorously tested to BS 6180 and fully approved for residential and commercial projects.

For more information, please go to: www.swr-balustrade.co.uk/regs

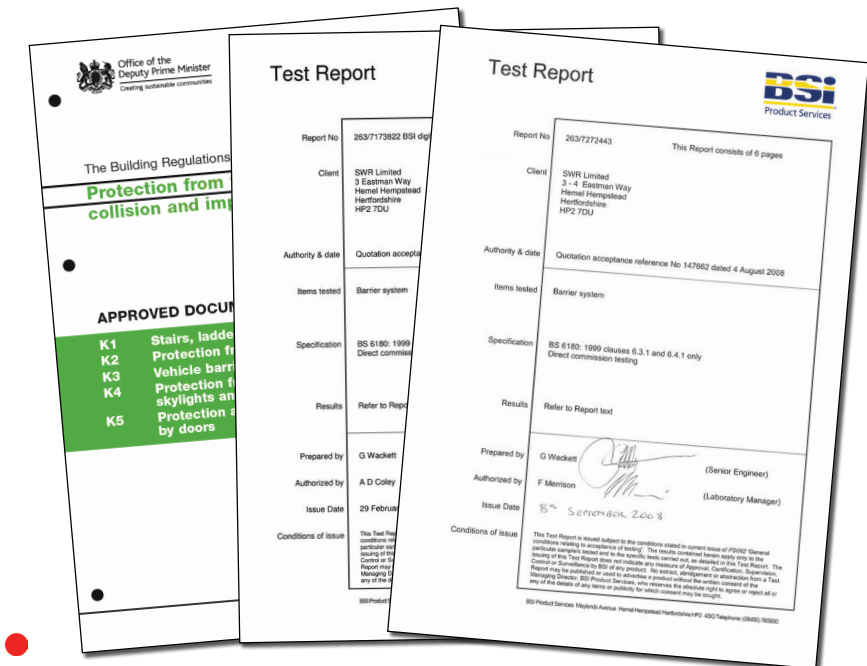

bsi.

CUTTING, DRILLING & FINISHING SERVICE

Have your own design in mind? Our CAD technicians will create technical drawings of your system, designed to your specifications. Skilled engineers then cut, drill and tap the balustrade accordingly.

During production, we polish every tube giving it a smooth, clean finish ready for on-site assembly. Rigorous checks are also carried out (in line with ISO 9001:2008 procedures) to guarantee ease of use and simple assembly when on site.

We package and mark up each balustrade part for clear identification. It's the small details that make the difference and help you to install your balustrade system, safely and efficiently.



CLEANING & MAINTENANCE

As members of the British Stainless Steel Association, we advise that you clean your balustrade system to help retain its modern finish.

Our interior and exterior cleaning products are specifically designed for stainless steel - creating a sparkling appearance and protective film to help further its lifespan.



SWR EASY CLEAN

Description	Size	Part Code
Interior Cleaner	750ml	0000.60.015



SWR METAL SHINE

Description	Size	Part Code
Exterior Cleaner	750ml	0000.60.020

Your ideal balustrade system is just a few clicks away with our quick and easy Online Quote Configurator.

Simply select your product type, estimated length and the number of corners, and we'll contact you with a quote.

This process is fast and easy to use.
Visit: www.swr-balustrade.co.uk/quote

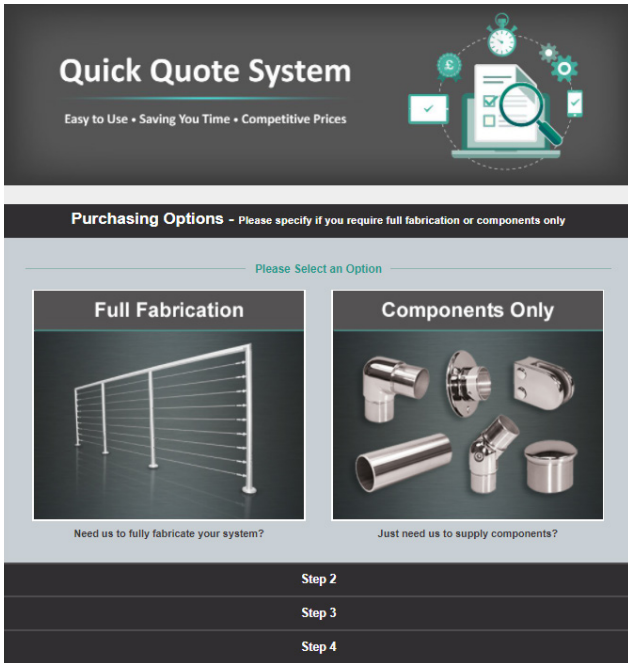

MODULAR SYSTEM - UPRIGHT POSTS

Step 1

Place your base plate down onto the surface. Ensure the full plate sits flush with no obstacles between the surface and the bottom of the base plate. Once in position, mark out the holes using the pre-drilled holes in the base plate. Continue this process for each base plate. ①



Step 2

Start to drill the holes once you are happy with their positioning. ②



ChemFix & Studding Method

The size of the studding will determine the size of the hole you need to drill. A hole one size up from the studding thickness is required.

i.e. M8 studding requires an M10 hole. An M10 studding requires a M12 hole etc.

Drill at least 100mm straight down into the surface. Once you have drilled the holes, dispose of any excess debris inside the hole. Calculate the length of each stud you are fitting into the hole. This can be calculated by taking the distance drilled into the ground plus 15mm. ③

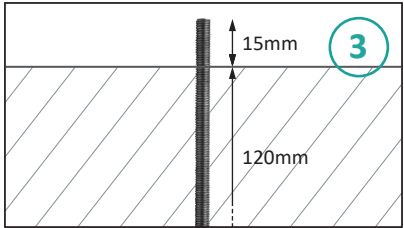

i.e. A hole that is 120mm into the ground: 120mm + 15mm = 135mm.

One piece of studding is required per hole drilled. Next, take your ChemFix and slowly apply into each hole. ④



PLEASE NOTE: ChemFix sets quickly. Once you have applied it to the first 9-12 holes, twist the studding into each hole. Remove any excess ChemFix before it sets. Repeat this procedure until all holes are filled and leave to set for 60 minutes. Remember to change the Applicator nozzle.

Next, place base plates back over the exposed studding. Then place washers, followed by nuts onto each piece of the studding. Tighten each nut so the base is securely fixed to the surface. Place covers over base plates to cover all exposed fixings. ⑤

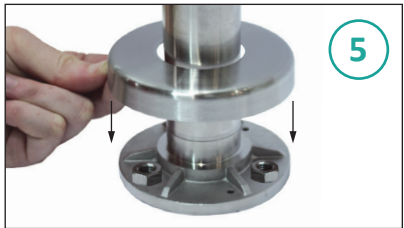

Step 3

Take upright posts and apply contact adhesive to the male fitting exposed from base plate.

PLEASE NOTE: Adhesive sets very quickly.

Place all upright posts over the exposed male fittings of the base plates. ⑥

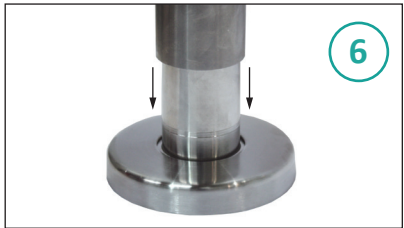

For further help fitting your Balustrade System, please contact our Sales Team.

MODULAR SYSTEM - HANDRAIL

Step 1 - Dry Run

Once all posts are fixed, place handrail supports into the top of each upright. ①

Place elbows into the ends of handrails and onto the fixed uprights. ②

Step 2

Tape supports to handrail using gauze tape. Remove handrail from the uprights ensuring the supports are securely taped in the same position as when the handrail was in place. ③

Step 3

Using a felt pen, mark the holes on the handrail where the handrail support is positioned. Un-tape the handrail supports once all holes are marked.

Step 4

Ensuring the handrail is securely positioned within a vice, place a small piece of gauze tape over the marked area and using a sharp point, gently mark a pilot hole into your handrail - this will help to drill your hole. Place lubricant onto your drill bit and drill holes. ④

Next, tap the drilled holes with the included tapper. Remove all tape once the holes are drilled and tapped. ⑤

Step 5

Replace your handrail supports by lining up holes in the supports with holes in the handrail.

Place fixings through the underside of your handrail support and tighten until the handrail is securely fixed. Repeat for all handrail supports. ⑥

Step 6

Apply adhesive onto the male fittings of your handrail supports and the male fitting of any elbows on the end of your handrail. Place the handrail supports and elbows into your uprights. ⑦

Step 7

For extra support, apply gauze tape to areas with adhesive. Leave to set for 24 hours.

For further help fitting your Balustrade System, please contact our Sales Team.

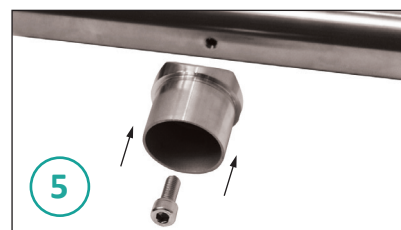
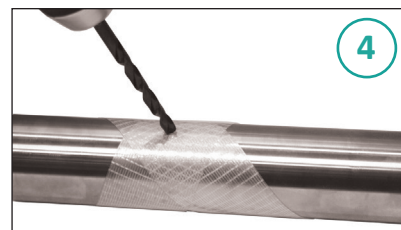
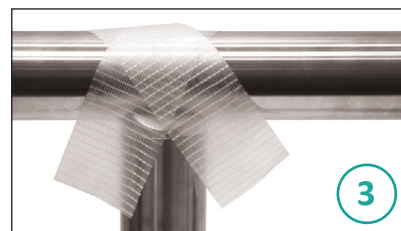
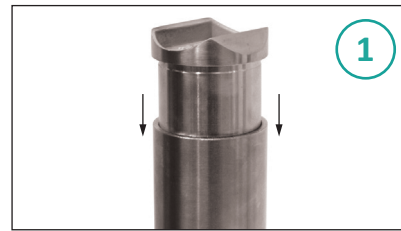

MODULAR SYSTEM - GLASS

Step 1

Remove glass brackets and correct sized rubbers from the packaging. Every glass bracket includes rubbers for 8mm and 10mm glass, a safety pin and an M8 x 20mm socket cap screw to fix the bracket to your upright. ①

PLEASE NOTE: Only use the safety pin when suspending glass at height. The clamping brackets and rubbers are strong enough to secure your glass in place.

Step 2

Apply the rubber to the inside of your bracket and fix the bracket body onto the upright. For your convenience, SWR pre-drill and tap these holes. Please refer to our **Handrail Fitting Instructions** if you need to drill and tap on site. Use a 6mm allen key to tighten the screw through the body of the glass bracket into your upright. ②

Step 3

Once all brackets are fixed to uprights, you must calculate the size of your glass. To comply with current buildings, a sphere with a 100mm diameter should not be able to pass through the gaps between the brackets and glass. This includes gaps between the upright posts and glass, the handrail and glass, and gap between the floor and glass.

To calculate the width of your glass, measure between the area within the glass bracket where you glass will rest, up to the same area on the opposing glass bracket. Subtract 10mm off the total for some tolerance. ③

i.e. Inside of glass bracket to inside of opposite glass bracket is 900mm
(900mm - 10mm = 890mm) Glass Width: 890mm

To calculate the height of your glass, measure from the ground to the underside of your handrail and subtract the size of the gap you wish to leave. Ensure this is no more than 100mm. We recommend a 70mm gap between the handrail and the glass, and gap between the floor and glass. ④

i.e. From surface area to underside of handrail is 1050mm
(1050mm - 70mm - 70mm = 910mm) Glass Width: 910mm

If your glass panels are a "non-standard" shape, we advise that glass templates are made of MDF wood so it can be shaped into how you would like the glass to look. This must be strong enough for transportation via courier and onto our glazier for processing.

PLEASE NOTE: We are unable to supply any materials for glass templates. A service charge applies for collecting customer templates.

Step 4

Place glass into the glass brackets and tighten the clamp. Ensure the glass is securely clamped in all areas. ⑤

Important Information - Please Read

SWR will advise on the most suitable and safest system for each balustrade project. However, it is the customer's responsibility to ensure the final specification complies with building regulations. It is also the installers responsibility to ensure the area in which the system is to be fixed is structurally supportive and has been approved by a structural engineer.

For further help fitting your Balustrade System, please contact our Sales Team.

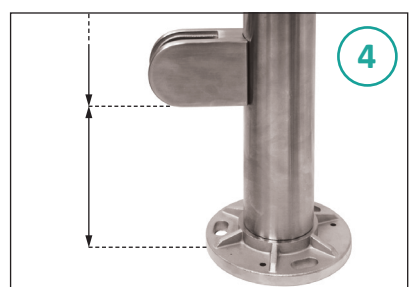
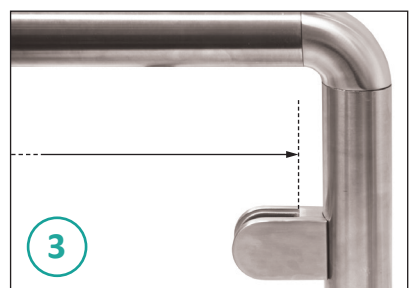
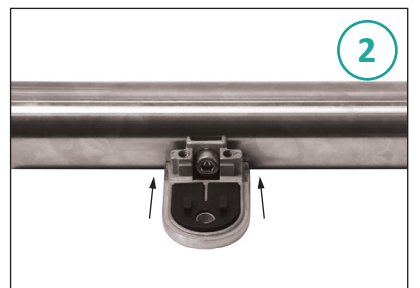
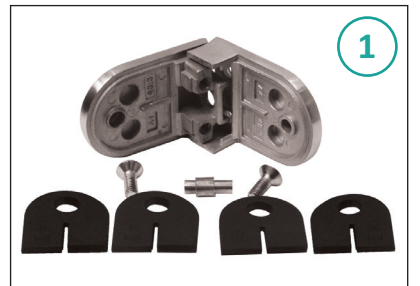

GLASS CHANNEL SYSTEM

For video instructions on how to install your glass channel system, please visit:
www.swr-balustrade.co.uk/glasschannel

Place aluminium channel against the fixing area and use as a template to mark out the holes for drilling. Remove channel and drill holes.

The size of the holes is determined by your fixing method. Please see the guide below for fixing into concrete or brick. For other surfaces, please contact our Sales Team.

PLEASE NOTE: If you are unsure on the quality of the structure you are fixing to, please seek the advice of a professional.

Concrete & Brick

We recommend ChemFix and studding for fixing to concrete or brick. You will need M12 threaded studding and M12 nuts and washers. Drill your holes using a 14mm drill bit. This allows space for the ChemFix and m12 studding. Cut your studding into equal lengths. The length of each piece will depend on how far into the substrate you intend to fix.

PLEASE NOTE: We advise the minimum distance to fix into your substrate is 120mm. However, the distance can be assessed on site.

If fixing distance is 120mm, allow 15mm of studding to be exposed through the hole in your channel. This will provide you with enough exposed studding for a nut and washer. ①

i.e. 120mm + 15mm = 135mm Therefore, each piece of studding will need to be cut to 135mm

After all holes are drilled with studding cut to the required lengths, slowly apply ChemFix into the holes.

PLEASE NOTE: ChemFix sets quickly. Once you have applied it to the first 9-12 holes, twist the studding into each hole. Remove any excess ChemFix before it sets. Repeat this procedure until all holes are filled and leave to set for 60 minutes. Remember to change the applicator nozzle. ②

Once ChemFix has set, place your channel back over the exposed studding and fix to the ground using washers and nuts. Position the glass clamps on the bottom of the glass when inserting into the channel.

Please see the recommended spacing of clamps for specified glass thicknesses below. All glass thicknesses have been tested under BSI6180 and documentation can be provided upon request. ③

19mm = 5 clamps per metre

15mm, 17.5mm & 21.5mm laminate = 4 clamps per metre

12mm = 3 clamps per metre

Once the glass panel is positioned in the channel with the clamps spaced correctly, you need to place in the clamp bars. Each clamp will require two clamping bars, one either side of the glass. Please ensure the screw faces the channel wall. ④

Next, tighten the clamp bars onto the glass by turning the bolt on the clamping bar anti-clockwise so that it begins to meet the channel wall. Ensure the glass is flush using a spirit level. We recommend tightening the clamps at either end of your glass panel before clamping the intermediates. ⑤

Ensure that all glass is securely clamped within the channel, and you are satisfied with the positioning. Next, clip on the aluminium cover seal. Take your rubber gasket and feed into the aluminium strip using lubricant. ⑥

PLEASE NOTE: Do not stretch the rubber gasket.

Clip the cover seal onto your channel by starting from one end and making your way down. Clip any end caps and side/bottom cladding on to finish.

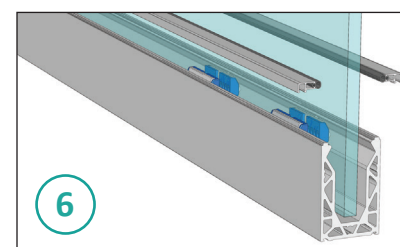
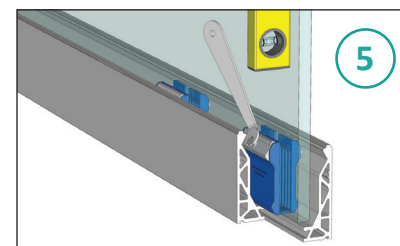
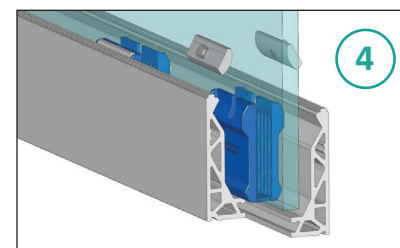
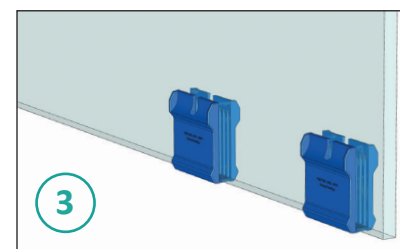
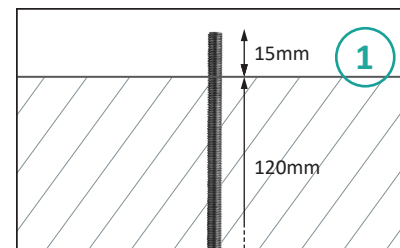

STAINLESS STEEL WIRE ROPE & COMPONENTS

Fully tested stainless steel wire rope and fittings for marine, architectural and structural applications.



1. GENERAL

- 1.1 All sales contracts of SWR Ltd. (herein referred to as "the Seller") shall be deemed to incorporate these conditions except in so far as these conditions are varied by any special conditions agreed in writing between the parties. Any terms and conditions in the purchase order which are inconsistent with these conditions shall have no effect.

2. CATALOGUES

- 2.1 Catalogues, price lists and any advertising matter published by the Seller are intended only to give an indication of the general nature of the goods available and nothing contained in any such catalogue, list or other matter shall be or be deemed to be a representation by the Seller or a condition or warranty affecting any goods sold.

3. PRICES

- 3.1 Unless otherwise expressly stated all quotations shall be valid for a fixed period of 30 days only.
- 3.2 Unless otherwise expressly agreed in writing the price payable for all goods supplied by the Seller shall be the price ruling at the date of despatch plus value added tax thereon at the rate ruling at the date of despatch. All prices are subject to change.

4. PAYMENT

- 4.1 All goods shall be paid for in full by the Purchaser to the Seller at the time of ordering, by cash, cheque, credit card or finance.
- 4.2 Where account facilities apply, having been expressly agreed in writing by the Seller, the price shall be paid in full by the Purchaser to the Seller within 30 days of the date of the invoice.
- 4.3 For all installation products and services purchased a deposit (shown overleaf) is required. This is payable on order confirmation. The balance is payable after the products have been delivered. If the seller is responsible for installation, this balance will be payable once the installation is complete, unless a finance agreement is in place.
- 4.4 The Seller reserves the right to charge interest at a rate 5% above the Barclays Bank base rate from the date when the price falls due for payment until the date on which such payments are actually received by the Seller, and in the case of any default in payment the Purchaser shall give the Seller every assistance in the repossession of the goods in respect of which payment has not been made.

5.0 DOOR STEP SELLING - COOLING OFF PERIOD

- 5.1 For orders signed away from the sellers normal premises (i.e. orders placed at your home, place of work or other third party premises) under the doorstep selling regulations act you are entitled to a statutory 7 working days cooling off period - beginning from the date you place your order. Certain goods are exempt from this cooling off period, for example a special order or goods which are personalised or made to a personal specification
- 5.2 You must inform us in writing during the cooling off period that you are cancelling the order by sending the below notice of cancellation to SWR Ltd. See point 11 below.
- 5.3 If you have not received the goods at the time of cancellation of the contract and we have not processed the goods for delivery, we will refund to you all the monies paid by you for the goods in question in the same form of payment originally used for the purchase as soon as possible and in any event within 30 days of your cancellation being accepted.
- 5.4 If applicable any related credit agreements will automatically be cancelled if the order is cancelled within the cooling off period mentioned in point.
- 5.5 If you do not return the goods to us we shall be entitled to deduct the direct costs of recovering the goods from the amount to be refunded to you.

6. TRANSFER OF TITLE

- 6.1 Title to goods shall only pass to the Purchaser from the date of payment in full of all sums payable to the Seller under the contract by which those goods were supplied or any other contract. Until such time, goods remain the absolute property of the Seller and the Purchaser shall keep them insured to their full invoice value. Such goods shall be stored in such a way that they are readily identifiable and the Seller shall be entitled to repossess such goods at its entire discretion and at any time prior to payment in full therefore. The Purchaser hereby grants the Seller, its servants and agents a licence to enter upon the Purchaser's premises for the purpose of repossessing the same. Such repossession shall not affect in any way the continued existence of any contract between the parties.
- If goods in which title has not passed to the Purchaser are subjected to any process, addition or treatment, the property in the goods so processed, added to or treated, shall be vested in the Seller until title has passed.
- 6.2 All goods sold by the Purchaser to third parties before title has passed to the Purchaser, shall be sold as agent for the Seller and all proceeds received from such sales shall be held by the Purchaser in trust for the Seller, until payment in full of all amounts outstanding has been received by the Seller.
- 6.3 Notwithstanding that property in any goods has not passed to the Purchaser, the Seller shall be entitled to sue the Purchaser for the price of such goods if not paid on the due date.

7. DELIVERY

- 7.1 Any time for the delivery stated by the Seller will be an estimate only on the likely time required to effect delivery from the date of receipt by the Seller of full and final instructions. The Seller will make every reasonable effort to comply with such estimate but the Purchaser shall have no right to damages or to cancel any contract with the Seller by reason only of failure on the part of the Seller to meet any stated delivery time.
- 7.2 The Seller will endeavour to comply with reasonable requests by the Purchaser for postponement of any stated delivery date but shall be under no enforceable obligation to do so. In the event of any such postponement at the request of the Purchaser, the Purchaser shall pay to the Seller on demand all costs and expenses thereby incurred including a reasonable charge for storage thereby occasioned.
- 7.3 When the goods are sold "carriage paid" by the Seller, delivery shall be deemed to take place at the moment the goods are lifted from the delivery vehicle and thereafter the goods shall be at the risk of the Purchaser in all respects.

8. DAMAGE IN TRANSIT

- 8.1 No claim for goods damaged or lost in transit will be accepted by the Seller unless written notification of such damage or loss is given to the Seller by the Purchaser and the carrier within four working days of receipt of the goods by the Purchaser and all damaged goods are retained by the Purchaser pending inspection by the Seller and carrier.

9. LIABILITY

- 9.1 In placing an order with the Seller subject to these conditions the Purchaser is deemed to acknowledge that the Purchaser is not dealing as a consumer and that the provisions of these conditions restricting the liability of the Seller are (save as may be notified in writing by the Purchaser to the Seller before the time at which such order is accepted) fair and reasonable in the light of all circumstances then known to the Purchaser.
- 9.2 All goods supplied by the Seller are fit for the normal purpose for which such goods are intended. No liability is accepted if the goods are found not to be fit for any other purpose whether or not such other purpose was made known to the Seller before the contract was made. Any recommendations made by the Seller in such circumstances are made in good faith but as the conditions of use are outside the control of the Seller, it is for the Purchaser to satisfy himself as to the suitability of the goods. Save as aforesaid any conditions or warranty implied or imposed by law as to the quality fitness for the purpose or otherwise however of any goods supplied by the Seller is hereby expressly excluded and in no circumstances (except death or injury caused by the Seller's negligence) shall the Seller be liable for any loss injury or damage caused or arising whether in contract or in tort save as expressly provided and to the extent provided in this condition.
- 9.3 If any defect in workmanship or materials shall manifest itself in any goods supplied by the Seller within 12 months of the date of delivery thereof provided always that the goods shall have been found not to be to specification the Seller shall have the right at its sole discretion to replace free of cost to the Purchaser (other than the cost of carriage) any such goods or parts thereof and the Purchaser shall be obliged to accept such replacement in full satisfaction of its claim and shall also return to the Seller at the expense of the Purchaser the goods originally delivered or such defective part thereof as may have been replaced. If the Seller shall fail to replace such goods or parts thereof any amount recoverable by way of damages from the Seller by the Purchaser shall be limited to the difference between the value of the goods at the time of the delivery to the Purchaser and no claim whatever by the Purchaser shall entitle the Purchaser to withhold payment of the price of any goods or to any right of set-off against any payment due to the Seller under any contract made by the Seller and the Purchaser, nor will any claim made by the Purchaser entitle the Purchaser to reject any goods supplied and treat the contract as repudiated and any remedy of the Purchaser shall be in damages only as hereinafter provided.
- 9.4 The Seller shall be under no liability in respect of any defect arising from fair wear and tear, willful damage, negligence, abnormal working conditions, failure to follow the Sellers instructions, whether oral or in writing, misuse or alterations of the Goods without the Seller's approval.
- 9.5 Given the multitude of legislations, we cannot accept liability for the compliance of our products to local building regulations. We therefore would like to draw your attention to the fact that it is always the customer's responsibility for observing the existing legal regulations and advice should be sort from your local planning office.

10. FORCE MAJEURE

- 10.1 In the event of any act of God, outbreak of war either general or local, riot or other civil commotion, strike lock-out or act or decree of any government or any other matter or thing beyond reasonable control of the Seller, the Seller:
- 10.2 Shall not be liable for any injury or damage of any kind thereby caused or resulting therefrom; and
- 10.3 May at the sole discretion of the Seller withdraw wholly or in part from the contract without any liability whatsoever. The construction validity and performance of this contract shall be governed by the laws of England and all disputes which may arise under out of or in connection with or in relation to this contract shall be subject to the jurisdiction of the courts of England.

